

# ELEVATION CERTIFICATE

OMB No. 1660-0008  
Expires February 28, 2009

Important: Read the instructions on pages 1-8.

SECTION A - PROPERTY INFORMATION		For Insurance Company Use:
A1. Building Owner's Name <u>Michael M. Pacheco</u>	Policy Number	
A2. Building Street Address (including Apt., Unit, Suite, and/or Bldg. No.) or P.O. Route and Box No. <u># 5 ROAD 4381</u>	Company NAIC Number	
City <u>Blanco</u> State <u>New Mexico</u> ZIP Code <u>87412</u>		
A3. Property Description (Lot and Block Numbers, Tax Parcel Number, Legal Description, etc.) <u>Book 1379 Page 831</u>		
A4. Building Use (e.g., Residential, Non-Residential, Addition, Accessory, etc.) <u>Residential</u>		
A5. Latitude/Longitude: Lat. <u>36°45' 27.37" N</u> Long. <u>107°45' 28.85" W</u> Horizontal Datum: <input type="checkbox"/> NAD 1927 <input checked="" type="checkbox"/> NAD 1983		
A6. Attach at least 2 photographs of the building if the Certificate is being used to obtain flood insurance.		
A7. Building Diagram Number <u>8</u>		
A8. For a building with a crawl space or enclosure(s), provide:		A9. For a building with an attached garage, provide:
a) Square footage of crawl space or enclosure(s) <u>1568</u> sq ft	a) Square footage of attached garage <u>NA</u> sq ft	b) No. of permanent flood openings in the attached garage walls within 1.0 foot above adjacent grade <u>8</u> sq in
b) No. of permanent flood openings in the crawl space or enclosure(s) walls within 1.0 foot above adjacent grade <u>0</u> sq in		
c) Total net area of flood openings in A8.b <u>0</u> sq in		

SECTION B - FLOOD INSURANCE RATE MAP (FIRM) INFORMATION					
B1. NFIP Community Name & Community Number <u>SAN JUAN County 3650064-0525</u>		B2. County Name <u>SAN JUAN</u>		B3. State <u>New Mexico</u>	
B4. Map/Panel Number <u>575</u>	B5. Suffix	B6. FIRM Index Date <u>8-4-88</u>	B7. FIRM Panel Effective/Revised Date <u>8-4-88</u>	B8. Flood Zone(s) <u>A</u>	B9. Base Flood Elevation(s) (Zone AO, use base flood depth)
B10. Indicate the source of the Base Flood Elevation (BFE) data or base flood depth entered in Item B9. <input type="checkbox"/> FIS Profile <input type="checkbox"/> FIRM <input type="checkbox"/> Community Determined <input type="checkbox"/> Other (Describe) _____					
B11. Indicate elevation datum used for BFE in Item B9: <input type="checkbox"/> NGVD 1929 <input type="checkbox"/> NAVD 1988 <input type="checkbox"/> Other (Describe) _____					
B12. Is the building located in a Coastal Barrier Resources System (CBRS) area or Otherwise Protected Area (OPA)? <input type="checkbox"/> Yes <input checked="" type="checkbox"/> No Designation Date _____ <input type="checkbox"/> CBRS <input type="checkbox"/> OPA					

SECTION C - BUILDING ELEVATION INFORMATION (SURVEY REQUIRED)	
C1. Building elevations are based on: <input type="checkbox"/> Construction Drawings* <input type="checkbox"/> Building Under Construction* <input checked="" type="checkbox"/> Finished Construction *A new Elevation Certificate will be required when construction of the building is complete.	
C2. Elevations - Zones A1-A30, AE, AH, A (with BFE), VE, V1-V30, V (with BFE), AR, AR/A, AR/AE, AR/A1-A30, AR/AH, AR/AO. Complete Items C2.a-g below according to the building diagram specified in Item A7. Benchmark Utilized <u>"AZCN" AZTEC Coes</u> Vertical Datum <u>6183.21</u> Conversion/Comments _____	
Check the measurement used.	
a) Top of bottom floor (including basement, <u>crawl space</u> or enclosure floor) <u>5612.36</u> feet <input checked="" type="checkbox"/>	<input type="checkbox"/> meters (Puerto Rico only)
b) Top of the next higher floor <u>5615.77</u> feet <input checked="" type="checkbox"/>	<input type="checkbox"/> meters (Puerto Rico only)
c) Bottom of the lowest horizontal structural member (V Zones only) <u>NA</u> feet <input type="checkbox"/>	<input type="checkbox"/> meters (Puerto Rico only)
d) Attached garage (top of slab) <u>NA</u> feet <input type="checkbox"/>	<input type="checkbox"/> meters (Puerto Rico only)
e) Lowest elevation of machinery or equipment servicing the building (Describe type of equipment in Comments) <u>NA</u> feet <input type="checkbox"/>	<input type="checkbox"/> meters (Puerto Rico only)
f) Lowest adjacent (finished) grade (LAG) <u>5612.50</u> feet <input checked="" type="checkbox"/>	<input type="checkbox"/> meters (Puerto Rico only)
g) Highest adjacent (finished) grade (HAG) <u>5612.70</u> feet <input checked="" type="checkbox"/>	<input type="checkbox"/> meters (Puerto Rico only)

SECTION D - SURVEYOR, ENGINEER, OR ARCHITECT CERTIFICATION			
This certification is to be signed and sealed by a land surveyor, engineer, or architect authorized by law to certify elevation information. I certify that the information on this Certificate represents my best efforts to interpret the data available. I understand that any false statement may be punishable by fine or imprisonment under 18 U.S. Code, Section 1001.			
<input type="checkbox"/> Check here if comments are provided on back of form.			
Certifier's Name <u>David R. Russell</u>	License Number <u>10201</u>		
Title <u>Licensed Surveyor</u>	Company Name <u>Russell Surveying Inc.</u>		
Address <u>1409 W. AZTEC BLVD #3</u>	City <u>AZTEC</u>	State <u>N.M.</u>	ZIP Code <u>87410</u>
Signature <u>David R. Russell</u>	Date <u>Nov 19, 2008</u>	Telephone <u>505-334-8687</u>	

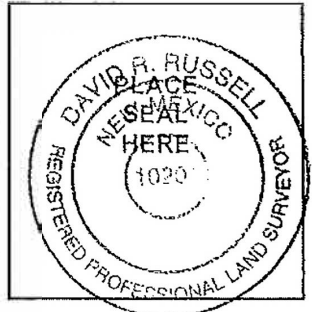

<b>IMPORTANT: In these spaces, copy the corresponding information from Section A.</b>		For Insurance Company Use:
Building Street Address (including Apt., Unit, Suite, and/or Bldg. No.) or P.O. Route and Box No. #5 ROAD 4381		Policy Number
City BLANCO	State New Mexico	Company NAIC Number
		ZIP Code 87412

**SECTION D - SURVEYOR, ENGINEER, OR ARCHITECT CERTIFICATION (CONTINUED)**

Copy both sides of this Elevation Certificate for (1) community official, (2) insurance agent/company, and (3) building owner.

Comments

Signature

Date

Check here if attachments

**SECTION E - BUILDING ELEVATION INFORMATION (SURVEY NOT REQUIRED) FOR ZONE AO AND ZONE A (WITHOUT BFE)**

For Zones AO and A (without BFE), complete Items E1-E5. If the Certificate is intended to support a LOMA or LOMR-F request, complete Sections A, B, and C. For Items E1-E4, use natural grade, if available. Check the measurement used. In Puerto Rico only, enter meters.

- E1. Provide elevation information for the following and check the appropriate boxes to show whether the elevation is above or below the highest adjacent grade (HAG) and the lowest adjacent grade (LAG).
- a) Top of bottom floor (including basement, crawl space) or enclosure is 5612.36  feet  meters  above or  below the HAG.
- b) Top of bottom floor (including basement, crawl space, or enclosure) is 5615.77  feet  meters  above or  below the LAG.
- E2. For Building Diagrams 6-8 with permanent flood openings provided in Section A items 8 and/or 9 (see page 8 of Instructions), the next higher floor (elevation C2.b in the diagrams) of the building is N/A  feet  meters  above or  below the HAG.
- E3. Attached garage (top of slab) is N/A  feet  meters  above or  below the HAG.
- E4. Top of platform of machinery and/or equipment servicing the building is N/A  feet  meters  above or  below the HAG.
- E5. Zone AO only: If no flood depth number is available, is the top of the bottom floor elevated in accordance with the community's floodplain management ordinance?  Yes  No  Unknown. The local official must certify this information in Section G.

**SECTION F - PROPERTY OWNER (OR OWNER'S REPRESENTATIVE) CERTIFICATION**

The property owner or owner's authorized representative who completes Sections A, B, and E for Zone A (without a FEMA-issued or community-issued BFE) or Zone AO must sign here. The statements in Sections A, B, and E are correct to the best of my knowledge.

Property Owner's or Owner's Authorized Representative's Name

Address

City

State

ZIP Code

Signature

Date

Telephone

Comments

Check here if attachments

**SECTION G - COMMUNITY INFORMATION (OPTIONAL)**

The local official who is authorized by law or ordinance to administer the community's floodplain management ordinance can complete Sections A, B, C (or E), and G of this Elevation Certificate. Complete the applicable item(s) and sign below. Check the measurement used in Items G8 and G9.

- G1.  The information in Section C was taken from other documentation that has been signed and sealed by a licensed surveyor, engineer, or architect who is authorized by law to certify elevation information. (Indicate the source and date of the elevation data in the Comments area below.)
- G2.  A community official completed Section E for a building located in Zone A (without a FEMA-issued or community-issued BFE) or Zone AO.
- G3.  The following information (Items G4.-G9.) is provided for community floodplain management purposes.

G4. Permit Number	G5. Date Permit Issued	G6. Date Certificate Of Compliance/Occupancy Issued
-------------------	------------------------	---

G7. This permit has been issued for:  New Construction  Substantial Improvement

G8. Elevation of as-built lowest floor (including basement) of the building: \_\_\_\_\_  feet  meters (PR) Datum \_\_\_\_\_

G9. BFE or (in Zone AO) depth of flooding at the building site: \_\_\_\_\_  feet  meters (PR) Datum \_\_\_\_\_

Local Official's Name

Title

Community Name

Telephone

Signature

Date

Comments

Check here if attachments